

RACK-CLAD BUILDINGS

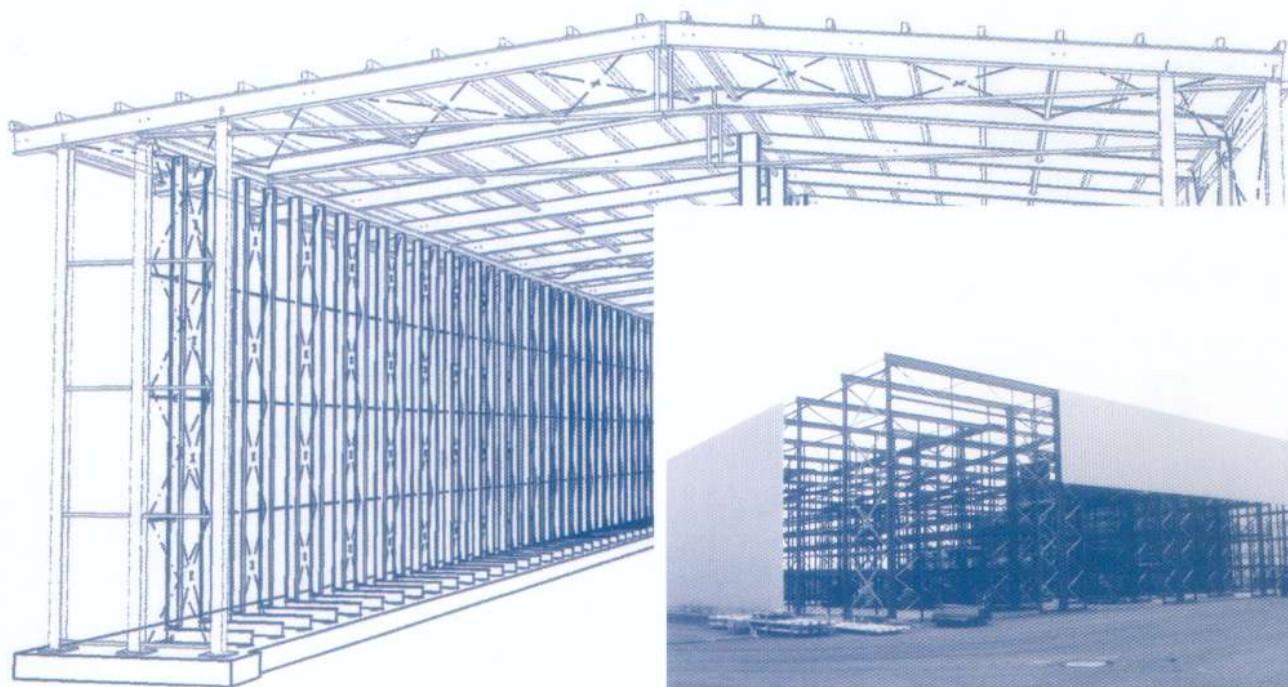

RACK-CLAD BUILDINGS



OHRA-Experience from more than 600 completed major projects

From the first on-site meeting we can provide you with ideas and suggestions for your rack-clad warehouse. For more than 20 years we plan and supply rack-clad

buildings in Europe and abroad. We plan and produce small shelter buildings for tools and devices, workshop buildings with integrated cranes for e.g. timber or PVC trader, and major logistics projects for international operating big companies.

The first step is to work out a utilization layout under consideration of your material flow. OHRA planning is always designed and projected from inside to outside. Together with production and commissioning areas, traffic routes, racking systems etc. we work out the first layout.



0162 365 60 51

RACK-CLAD BUILDINGS



Pallet and/or Cantilever racking as supporting elements for roof and wall

...and therefore the usual steel frame work is not required. A significant cost advantage from the building permission up to the moving in.

Both pallet racking and Cantilever racking from OHRA meet two functions: on one hand of course that of a mature racking

and storage system but on the other hand as supporting construction for roof and wall. Thus provides a basics for a rack-clad building which can fulfil all demands of a conventional building: a free span of up to 30 mtrs. Or a full insulated warehouse building with doors, gates, light, smoke outlet etc...



Partial closed roofing, complete construction

The rack-clad building construction starts with a simple roof of single pallet or Cantilever racking with different roofing profiles, e.g. sandwich elements with anti-drip coating and spacious lighting plates. In most cases the outer racking lines are fully or partially closed with cladding panels in sandwich construction, or with sheet pile profiles

according to the desire and demand to the goods or the room conditions. As further extension the gable end can be fully or partially reveted with cladding panels. In case of installation of doors and gates (e.g. sliding gates, sectional gates etc.), windows, illumination, smoke outlets the rack-clad building converts to a high-value complete warehouse up to a turn-key delivery by OHRA.



0162 365 60 51

GENERAL OUTLAY

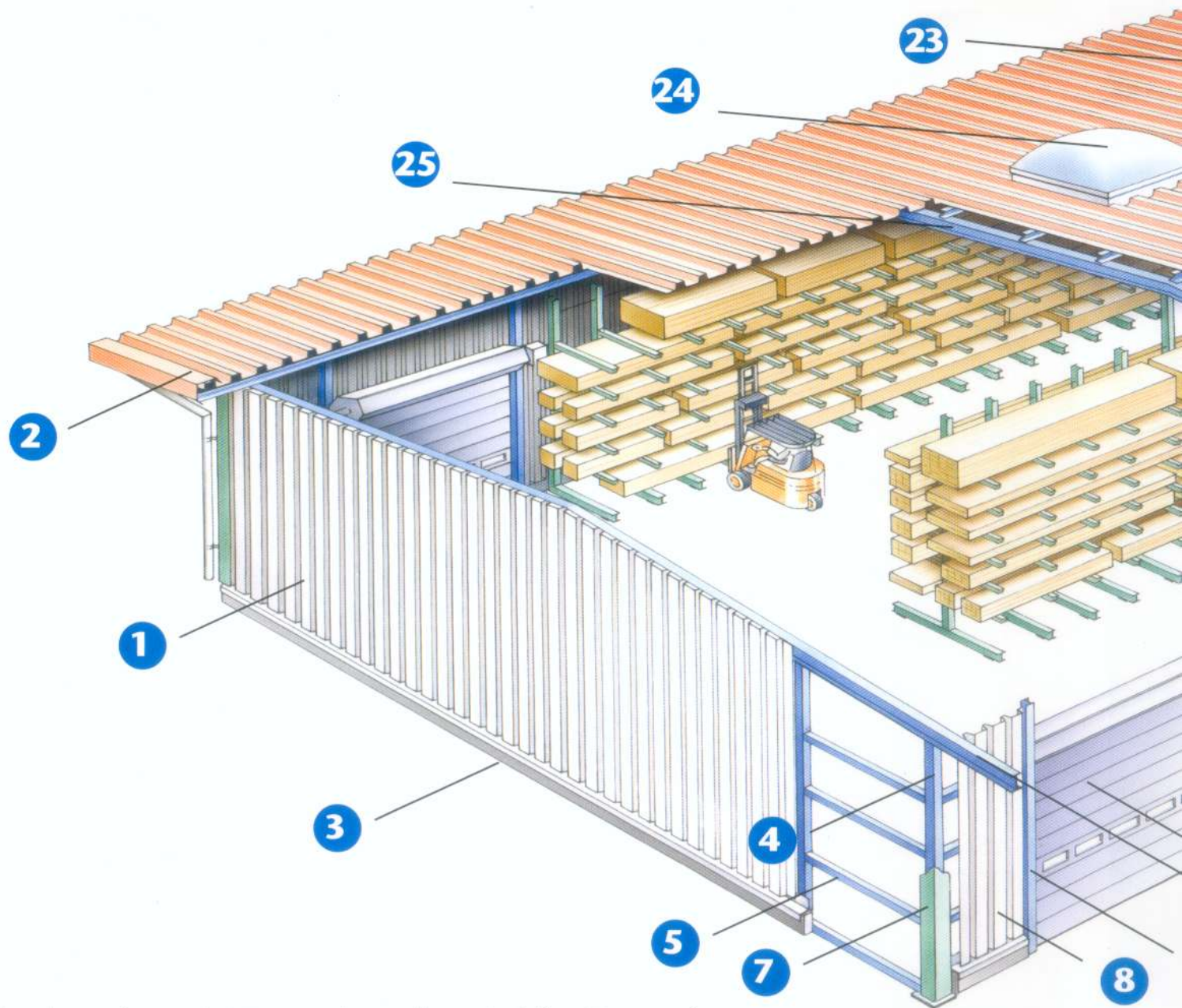

The scheme demonstrates a sample warehouse building. The warehouse type and fitting will be produced according to your desires and demands.

- | | | | | |
|---|---|---|--|---|
| 1 Gable wall covering with trapezoidal sheet metal | 6 verge flashing | 11 escape door | 15 horizontal flashing | 21 roof covering trapezoidal sheet metal (according to customer requirement) |
| 2 verge sheet metal | 7 corner protecting sheet metal | 12 Cantilever racking (as supporting construction) | 16 steel mezzanine | 22 ridge plate |
| 3 horizontal flashing | 8 longitudinal wall covering trapezoidal sheet metal | 13 longitudinal wall covering sheet pile profile | 17 pallet racking (possible as supporting construction) | 23 lighting plate |
| 4 gable supporting pillar | 9 gate supporting pillar | 14 sectional gate with escape door | 18 down pipe | 24 domelight |
| 5 wall supporting bar | 10 sliding gate | | 19 gutter | 25 roof truss |
| | | | 20 purlin | |

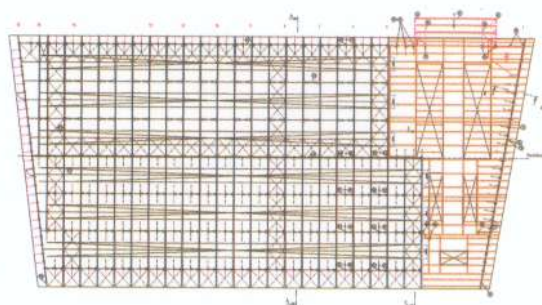
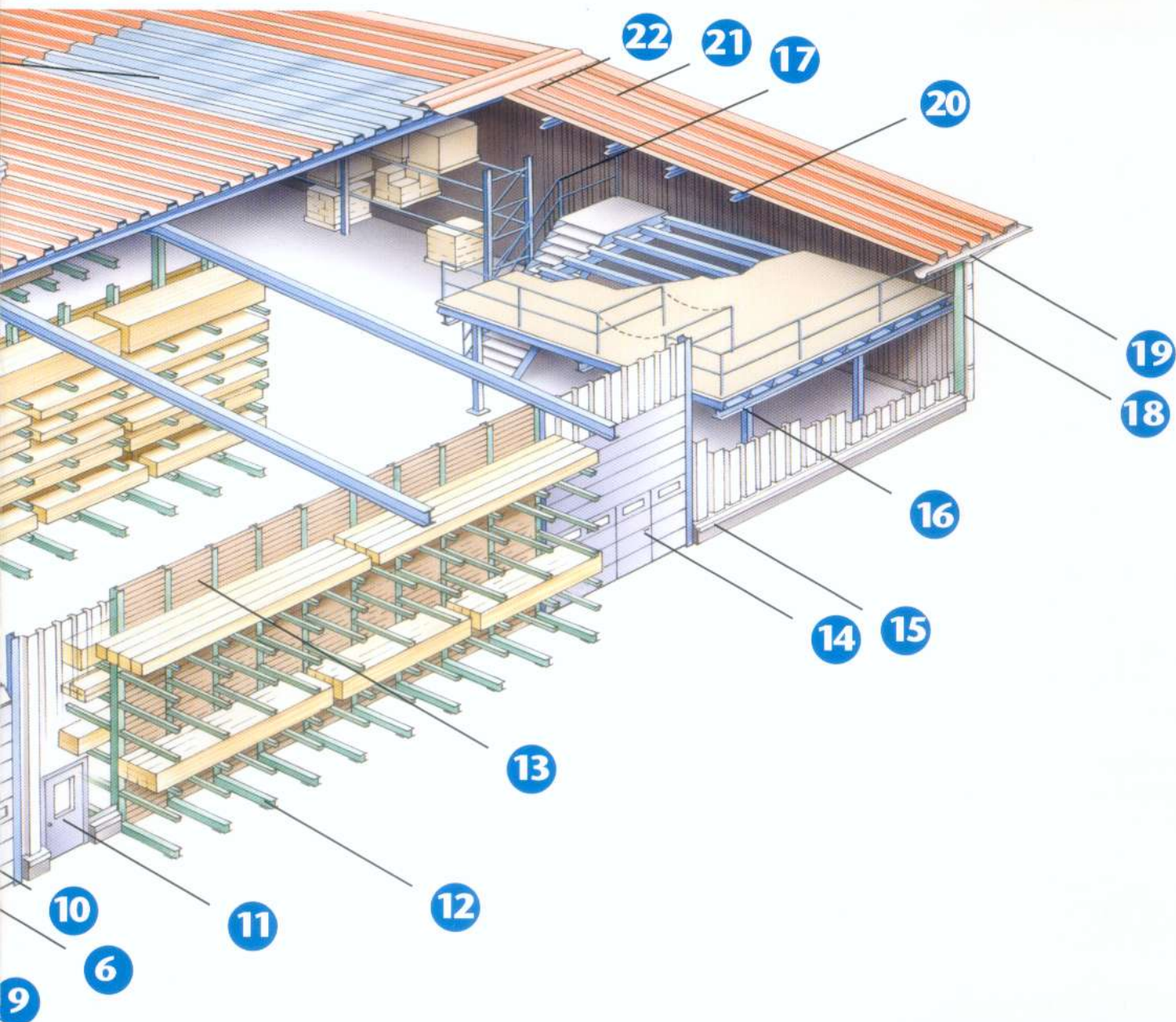

www.ohra.net



On the Internet you will find OHRA with references to design models, accessories, references and suggestions.



uk@ohra.de

RACK-CLAD BUILDINGS



Monopitch roof, attic, ridge roof

The roof type can be achieved with different constructions. These often depend on the buildings in the environs. Basically one can distinguish between monopitch and saddle roof. Behind an attic construction it is possible to hide different roofing types due to cosmetic reasons. The under-construction of the

roof is normally realised with steel girders which are fixed on top of the racking system and reach a free span of up to 30 mtrs. The roof covering can be made of single-sided trapezoidal sheet metal or trapezoidal sheet profiles up to a heat-insulating covering with spacious lighting plates including smoke outlet systems..



RACK-CLAD BUILDINGS



On request we take care of all works, and as general supplier we take on the responsibility for your total new building project. The cost advantage of an OHRA rack-clad building is the deciding factor for your

and our success because the racking supports the roof and the wall. An independent steel construction such as a conventional warehouse building has not to be applied. Despite an extensive standardized

construction portfolio, a lot of individual constructions are possible. Finally your rack-clad warehouse meets your specific requirements.



www.ohra.net

RACK-CLAD BUILDINGS



Advantages you can realise with a OHRA rack-clad building:

- Cost advantage, because the racking system supports the roof and wall construction.
- Cost advantage through numerous building models and fitting possibilities
- Up to 15% cost advantage through OHRA planning incl. architectural services
- Time advantage because of short realisation time for the total building
- Security advantage because OHRA provides a turn-key construction
- Advantage because OHRA is also expert for logistics tasks, material flow and forklift truck technologies etc.
- Advice advantage because OHRA is near your site in

the whole of Europe

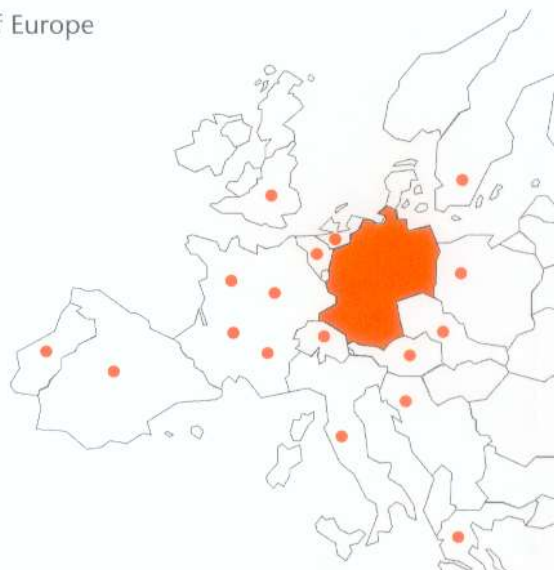

Total solutions

Delegate your detailed planning and execution of your building to OHRA:

- Storage optimization and capacity planning
- Drawings and CAD-planning
- Workout of required static calculations
- Total planning and coordination of different works
- Construction site monitoring
- Racking systems layout
- Turn-key constructions



Mostly all buildings and warehouses can be divided in different basic models according to the material flow: Here we show 4 from 18 of our rack-clad building models.



As roof construction we mostly use steel frameworks.



OHRA 
RACKING SOLUTIONS

Alfred-Nobel-Str. 24-44, D-50169 Kerpen, E-mail: info@OHRA.de

sales office UK: Tel.: 0162 365 60 43, Fax: 0162 365 60 51, E-mail: uk@ohra.de